

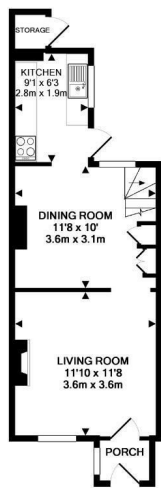

Keith
Ashton

Cromwell Road, Warley
Brentwood



GROUND FLOOR
APPROX. FLOOR
AREA: 330 SQ. FT.
(30.7 SQ. M.)

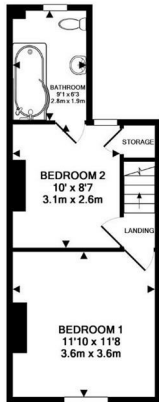

1ST FLOOR
APPROX. FLOOR
AREA: 300 SQ. FT.
(27.9 SQ. M.)



5 Cromwell Road, Warley, Brentwood, CM14 5DT

Situated within a short walk of Brentwood Mainline Station, with the imminent arrival of Crossrail, is this extremely well presented two bedroom character cottage.

A neat shingled front garden leads to the entrance porch which gives access to the light and spacious lounge, with a modern feature fire and a wood floor, which in turn leads to an attractive dining room with stairs leading to the first floor. You will find a contemporary fitted kitchen located to the rear of the property, just off the dining room. The first floor is where you will find two double bedrooms and a good sized luxury white bathroom suite, including a p-shaped bath with shower over. Externally the cottage boasts a long garden with a large decking area, perfect for outside entertaining.

Guide Price £340,000

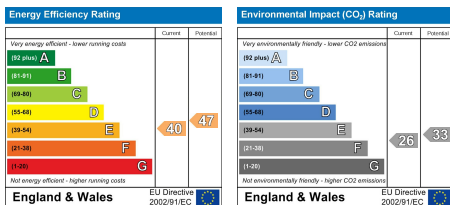

SERVICES:

Local Authority: Brentwood
Council tax band: C
Post code: CM14 5DT

VIEWING:

Strictly by prior arrangement with Keith Ashton Estate Agents

OPENING HOURS:

Monday to Friday: 8.45AM - 6.30PM | Saturdays: 9AM - 5.30PM | Sundays: 10AM - 2PM

MORTGAGE INFORMATION: We offer the additional facility of an in-house Independent Financial Adviser who will access all mortgage lenders with the purpose of providing you with the benefit of choice. For quotations or comparables please call 01277 260858 or visit our interactive website at www.mortgagebusiness.net



WE THE AGENT HAVE NOT TESTED ANY APPARATUS, FITTINGS OR SERVICES FOR THIS PROPERTY. THE PLOT SIZE IS INTENDED MERELY AS A GUIDE AND HAS NOT BEEN OFFICIAL MEASURED OR VERIFIED BY THE AGENT. PHOTOGRAPHS ARE FOR ILLUSTRATION ONLY AND MAY DEPICT ITEMS WHICH ARE NOT FOR SALE OR INCLUDED IN THE SALE OF THE PROPERTY.

Brentwood
Tel. 01277 260858

Village Office
Tel. 01277 375757

Lettings Office
Tel. 01277 202200

Explore more @ www.keithashton.co.uk